

Injection unit									
Type of injection		IU 350				IU 450			
Screw diameter	mm	46	52	58	65	52	58	65	75
Injection pressure	kg/cm ²	3175	2485	1998	1591	3145	2528	2013	1512
Theoretical shot volume	cm ³	386	493	613	770	552	687	863	1149
Shot weight (PS)	g	351	448	558	700	503	625	785	1045
Theoretical injection volume	cm ³ /sec	276	352	438	550	278	346	435	579
L/D Ratio	L/D	20	20	20	20	20	20	20	20
Plasticizing rate (PS)	kg/hr	146	200	282	354	172	242	304	404
Injection stroke	mm	232				260			
Max. injection speed	mm/sec	166				131			
Screw speed	r.p.m	350				300			
Nozzle contact force	ton	10.7				10.7			
Hopper Capacity	l	100				100			
Cylinder Temperature Control	zone	Cylinder x4 zones . Nozzle x1 zone							
Clamping unit									
Clamping system		Double toggle							
Clamping force	ton	450							
Opening stroke	mm	760							
Overall size of platens (H xV)	mm	1180x1180							
Distance between tie-bars (HxV)	mm	810x810							
Mould height	mm	350~750							
Max. daylight opening	mm	1510							
Ejector system		Hydraulic (17 points)							
Ejection stroke	mm	180							
Ejection force	ton	11.1							
General data									
Pump unit	kw	37							
Heating capacity of screw cylinder	kw	12.8	16.8	17	18	15	16.8	20.4	22.7
Total power capacity	kw	49.8	53.8	54	55	52	53.8	57.4	59.7
Oil tank capacity	l	543							
Net weight(without oil) approx.	ton	18.5							

E=Energy-Efficient Series

We reserve the right to make changes as a result of further technical advantages

VM 450E

Mold Dimensions Unit : mm

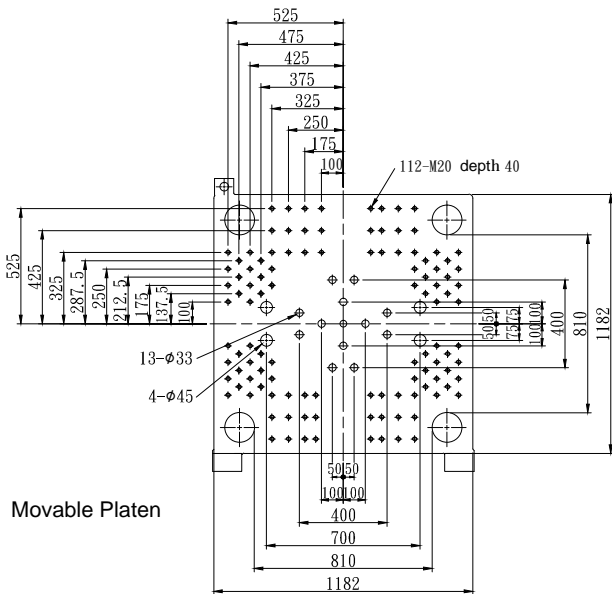

Movable Platen

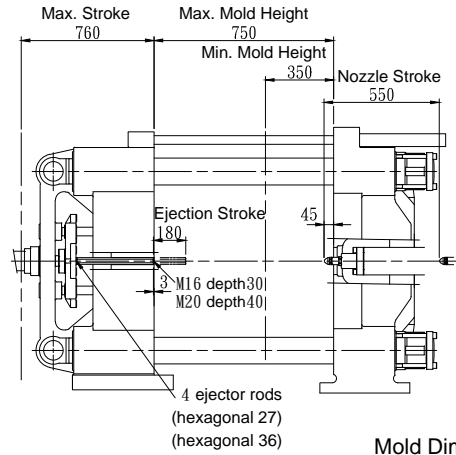

Mold Dimensions

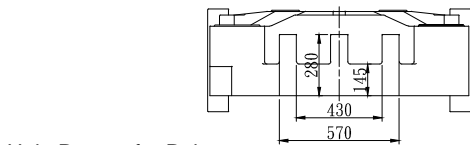

Hole Pattern for Robot

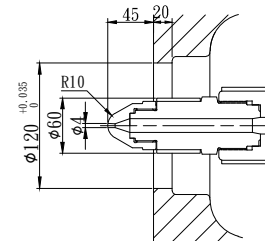

Nozzle Dimensions

Machine Dimensions Unit : mm

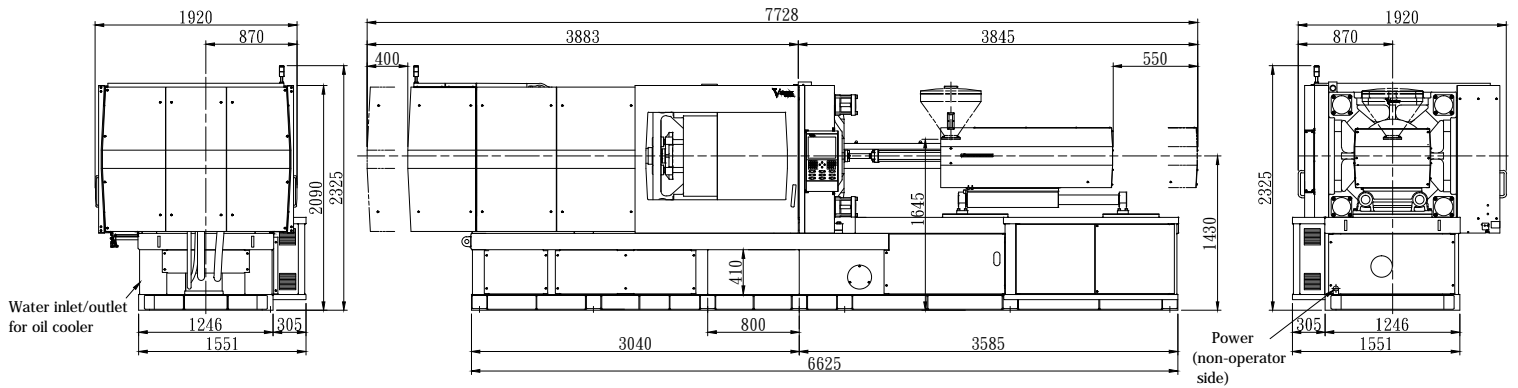

Water inlet/outlet for oil cooler

Power (non-operator side)