

Injection unit			
Type of injection	IU 450B		
Screw diameter	mm	70	75
Injection pressure	kg/cm ²	1866	1626
Theoretical shot volume	cm ³	1443	1657
Shot weight (PS)	g	1313	1508
Theoretical injection volume	cm ³ /sec	469	538
L/D Ratio	L/D	21.4	20
Plasticizing rate (PS)	kg/hr	293	337
Injection stroke	mm	375	
Max. injection speed	mm/sec	121	
Screw speed	r.p.m	250	
Nozzle contact force	ton	10.7	
Hopper Capacity	l	100	
Cylinder Temperature Control zone	Cylinder ×4 zones . Nozzle ×1 zone		
Clamping unit			
Clamping system	Double toggle		
Clamping force	ton	450	
Opening stroke	mm	760	
Overall size of platens (H×V)	mm	1180×1180	
Distance between tie-bars (H×V)	mm	810×810	
Mould height	mm	350~750	
Max. daylight opening	mm	1510	
Ejector system	Hydraulic (17 points)		
Ejection stroke	mm	180	
Ejection force	ton	11.1	
General data			
Pump unit	kw	37	
Heating capacity of screw cylinder	kw	21.3	22.7
Total power capacity	kw	58.3	59.7
Oil tank capacity	l	543	
Net weight(without oil) approx.	ton	n/a	

EB=Energy-Efficient Big Shot Size Series

We reserve the right to make changes as a result of further technical advantages

VM 450EB

Mold Dimensions Unit : mm

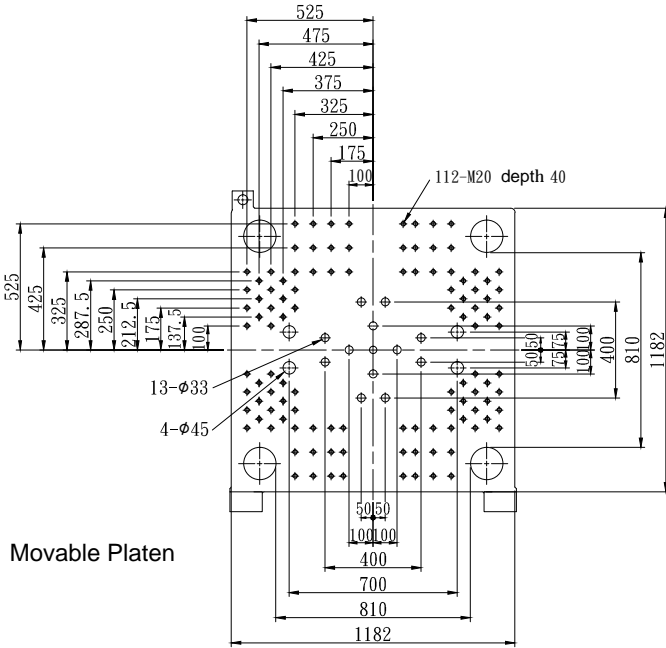

Movable Platen

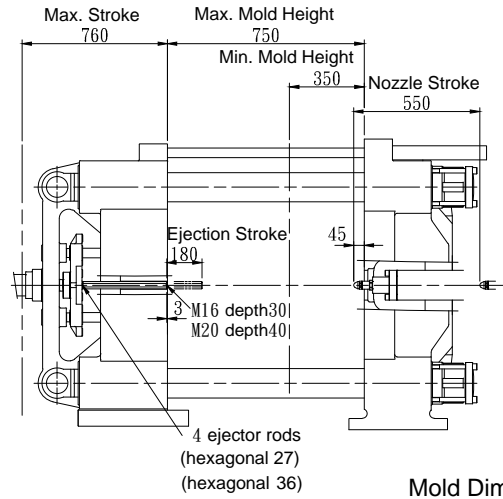

Mold Dimensions

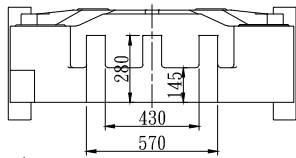

Hole Pattern for Robot

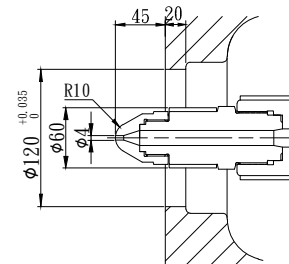

Nozzle Dimensions

Machine Dimensions Unit : mm

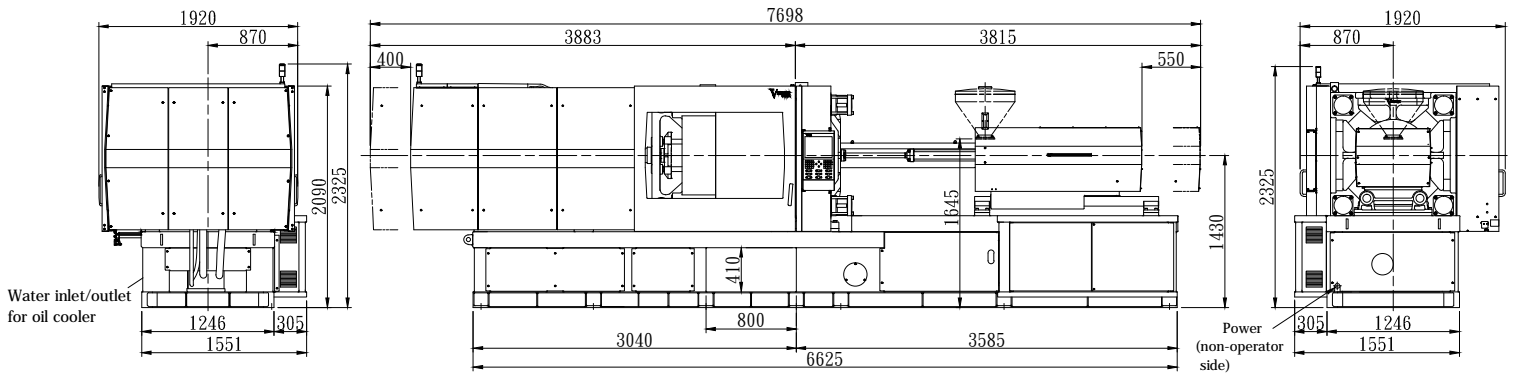

Water inlet/outlet for oil cooler

Power (non-operator side)