

Injection unit									
Type of injection		IU 450				IU 580			
Screw diameter	mm	52	58	65	75	58	65	75	85
Injection pressure	kg/cm <sup>2</sup>	3145	2528	2013	1512	3017	2402	1804	1405
Theoretical shot volume	cm <sup>3</sup>	552	687	863	1149	793	995	1325	1702
Shot weight (PS)	g	503	625	785	1045	721	906	1206	1549
Theoretical injection volume	cm <sup>3</sup> /sec	371	461	580	772	387	486	646	830
L/D Ratio	L/D	20	20	20	20	20	20	20	20
Plasticizing rate (PS)	kg/hr	200	282	354	472	226	283	377	570
Injection stroke	mm	260				300			
Max. injection speed	mm/sec	175				146			
Screw speed	r.p.m	350				280			
Nozzle contact force	ton	10.7				10.7			
Hopper Capacity	l	100				100			
Cylinder Temperature Control	zone	Cylinder x4 zones . Nozzle x1 zone							
Clamping unit									
Clamping system		Double toggle							
Clamping force	ton	580							
Opening stroke	mm	850							
Overall size of platens (H xV)	mm	1340x1340							
Distance between tie-bars (HxV)	mm	910x910							
Mould height	mm	400-850							
Max. daylight opening	mm	1700							
Ejector system		Hydraulic (17 points)							
Ejection stroke	mm	180							
Ejection force	ton	11.1							
General data									
Pump unit	kw	25+25							
Heating capacity of screw cylinder	kw	15	16.8	20.4	22.7	17.4	20.2	26.6	29.4
Total power capacity	kw	65	66.8	70.4	72.7	67.4	70.2	76.6	79.4
Oil tank capacity	l	700							
Net weight(without oil) approx.	ton	25.5							

E=Energy-Efficient Series

We reserve the right to make changes as a result of further technical advantages

# VM 580E

Mold Dimensions Unit : mm

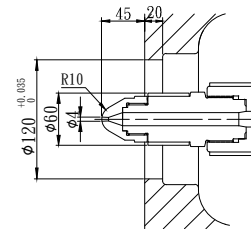
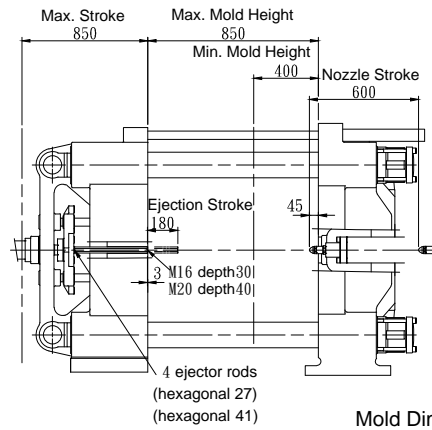
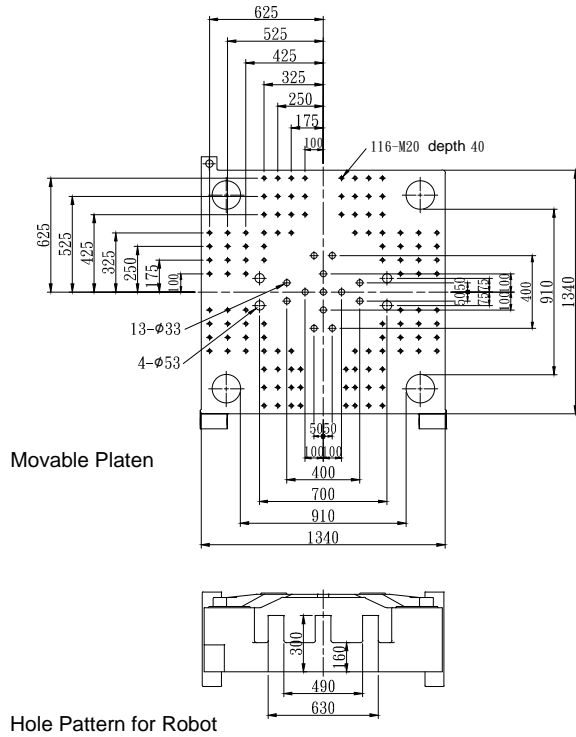

Machine Dimensions Unit : mm

